

Mixed Border Rain Garden

Sketch:

HALF MOON SHAPE - MIXED BORDER

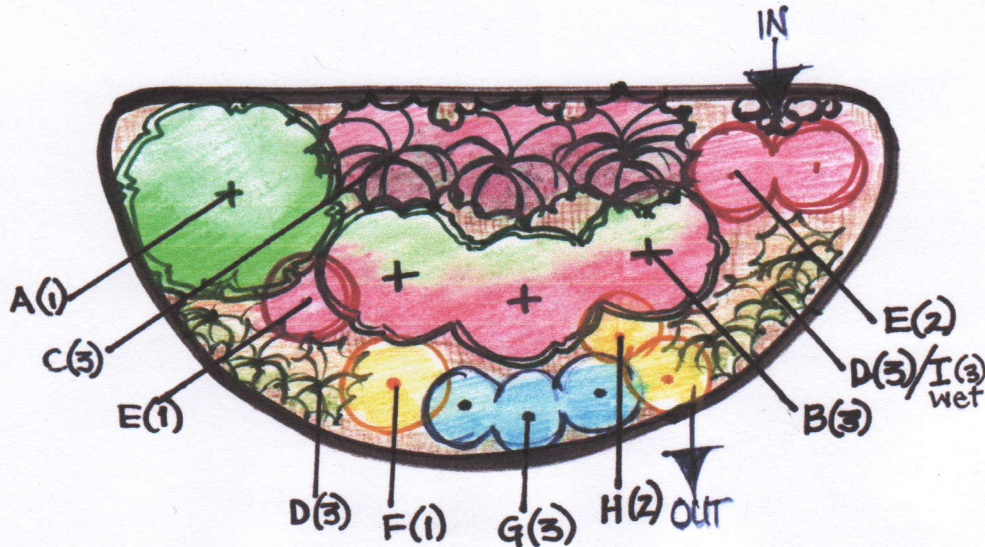
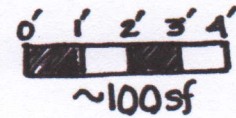

Description:

This ~100 square foot design is intended for rain gardens with depths of 5 to 8 inches. The majority of plants selected are native to Ohio.

The Mixed Border Rain Garden has a spine of woody shrubs, with grasses and colorful perennials arranged strategically for balance, and for color or texture combinations. Blooms, foliage or berries will color each season.

In Sun, the feature shrubs are either 'Red Sprite' Hollies, or a dark bronze Ninebark paired with a white flowering native shrub. Grasses are used for structure, color, texture and as edging.

In Shade, ferns and the native evergreen Arborvitae (part shade) or Hemlock (more shade) take the place of grasses. The Shade garden features Spicebush for its golden fall color and as food for the Spicebush Swallowtail caterpillar.

Sun Selections - Mixed Border Rain Garden:

	LATIN NAME	COMMON NAME	LIGHT	MOISTURE	QTY
A	<i>Ilex verticillata</i> male	Jim Dandy Holly	○ ●	⋈ ⋈	1
B	<i>Ilex verticillata</i> female	Red Sprite Holly	○ ●	⋈ ⋈	3
C	<i>Panicum virgatum</i>	prairie Fire Switch Grass	○ ●	⋈ ⋈	3
D	<i>Sporobolus heterolepis</i>	Prairie Dropseed	○	⋈ ⋈	3
E	<i>Lobelia cardinalis</i>	Cardinal Flower	○ ●	⋈	3
F	<i>Coreopsis palmata</i>	Plains Coreopsis	○	⋈	1
G	<i>Geranium</i>	x Rozanne	○ ●	⋈	3
H	<i>Helianthus angustifolius</i>	Low Down sunflower	○ ●	⋈ ⋈	2
I	<i>Carex strictca</i>	Tussock Sedge	○ ●	⋈	3
add	<i>Iris Versicolor</i>	Blue Flag Iris	○ ●	⋈	2

ALTERNATES:

24

A	<i>Physocarpus opulifolius</i>	Coppertina Ninebark	○ ●	⋈ ⋈	--
B	<i>Hydrangea arborescens</i>	Hayes Starburst Smooth Hydrangea*	○ ●	⋈	--
B	<i>Aronia melanocarpa</i>	Iroquois Beauty Black Chokeberry	○ ●	⋈ ⋈	--

* Will handle sun with consistent moisture

Shade Selections - Mixed Border Rain Garden:

	LATIN NAME	COMMON NAME	LIGHT	MOISTURE	QTY
A	<i>Lindera benzoin</i>	Spicebush	○ ●	⋈ ⋈	1
B	<i>Hydrangea Arborescens</i>	Smooth Hydrangea	○ ●	⋈	3
C	<i>Thuja Occidentalis</i>	Danica Dwarf Globe Arborvitae	○ ●	⋈ ⋈	3
D	<i>Polystichum acrostichoides</i>	Christmas Fern	○ ●	⋈ ⋈	3
E	<i>Lobelia cardinalis</i>	Cardinal Flower	○ ●	⋈	3
F	<i>Caltha palustris</i>	Marsh Marigold	○ ●	⋈	1
G	<i>Phlox stolonifera</i>	Purple Woodland Creeping Phlox	○ ●	⋈ ⋈	3
H	<i>Solidago caesia</i>	Bluestem Goldenrod	○ ●	⋈ ⋈	2
I	<i>Onoclea sensibilis</i>	Sensitive fern	○ ●	⋈	3
add	<i>Mertensia virginica</i>	Virginia Bluebells	○ ●	⋈	2

ALTERNATES:

24

C	<i>Tsuga canadensis</i>	Gentsch White dwarf Hemlock**	○ ●	⋈ ⋈	--
---	-------------------------	-------------------------------	-----	-----	----

** needs moist but well drained, slightly acidic soil

Key:

LIGHT LEVEL	○ ○● ●	Full Sun Part Sun/Part Shade Full Shade
MOISTURE LEVEL	⋈ ⋈ ⋈	Dry Average Moist to Wet